

## Selection of the most suitable AirCare device

There are mainly three factors that have an impact on selecting a suitable AirCare unit for a given room: size of space, amount of malodour and effectivity of air ventilation. Usually the best results can be achieved by following the below guidelines.

### AC-10

Small spaces (min. 5 m<sup>2</sup> - 42 m<sup>2</sup>)\*  
Low amount of unpleasant odour  
Very tidy general appearance

### AC-20

Medium sized spaces (min. 7 m<sup>2</sup> - 66 m<sup>2</sup>)\*  
Average amount of unpleasant odour  
Tidy general appearance  
Large amount of users

### AC-30

Large spaces (min. 16 m<sup>2</sup> - 147 m<sup>2</sup>)\*  
High amount of unpleasant odour  
Untidy spaces  
Several pissoirs or a large urinal

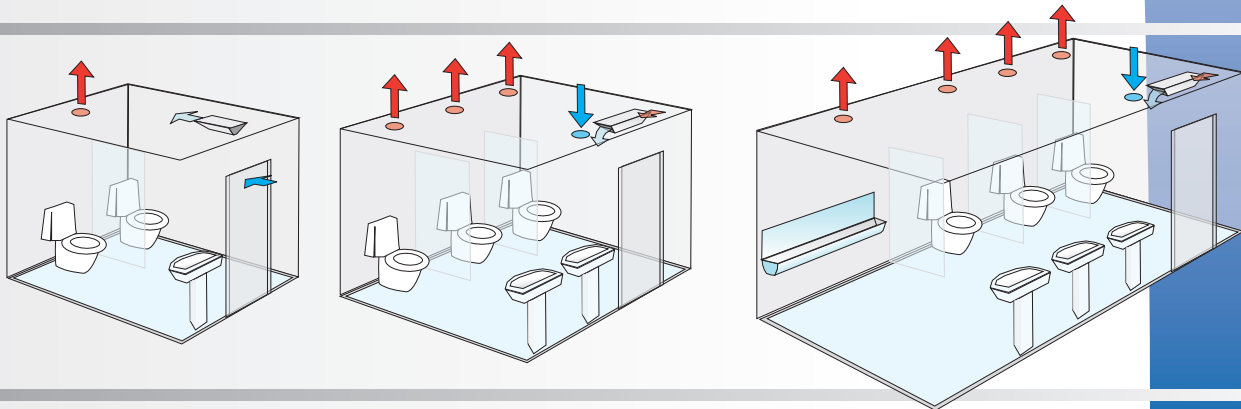

## Selection of proper location for installing AirCare unit

- AirCare unit operates most efficiently when installed close to incoming air vent, away from outgoing air vent
- The airflow from AirCare unit should be directed towards incoming air stream. This way photoplasma is mixed with the air circulation of the room
- The optimal height for installation is 2-2,5 m
- Installation on the ceiling is highly recommended
- When mounting AirCare unit to public space it is recommended to secure the contact box with a protective cover (available on request) and install the power cord tidily inside a wire channel of suitable size
- When following these basic principles most of the vandalism on the device can be prevented

